

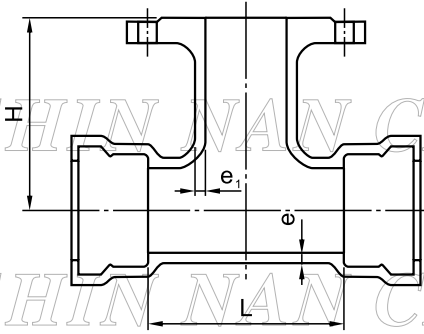

Flange on Tyton Tees

Unit : mm



Nominal size		e	e ₁	L	H	Mass with flange (Kg)			
Body DN	Branch dn					PN 10	PN 16	PN 25	
80	80	7.0	7.0	170	165	12.8	12.8	12.8	
	100	80	7.2	7.0	170	175	15.1	15.1	15.1
		100	7.2	7.2	190	180	16.1	16.1	16.6
150	80	7.8	7.0	170	205	22.2	22.2	22.2	
	100	80	7.8	7.2	195	210	23.5	23.5	24.0
		150	7.8	7.8	255	220	27.2	27.2	28.2
200	80	8.4	7.0	175	235	30.4	30.4	30.4	
	100	8.4	7.2	200	240	32.0	32.0	32.5	
	150	8.4	7.8	255	250	36.2	36.2	37.2	
	200	8.4	8.4	315	260	41.0	40.8	42.9	
250	80	9.0	7.0	180	265	40.4	40.4	40.4	
	100	9.0	7.2	200	270	42.0	42.0	42.5	
	150	9.0	7.8	260	280	47.0	47.0	48.0	
	200	9.0	8.4	315	290	52.3	52.1	54.2	
	250	9.0	9.0	375	300	58.7	58.3	62.2	
300	80	9.6	7.0	180	295	51.4	51.4	51.4	
	100	9.6	7.2	205	300	53.5	53.5	54.0	
	150	9.6	7.8	260	310	59.0	59.0	60.0	
	200	9.6	8.4	320	320	65.2	65.0	67.1	
	250	9.6	9.0	380	330	72.4	72.0	75.9	
	300	9.6	9.6	435	340	79.8	79.4	85.0	
350	80	10.2	7.0	185	325	64.3	64.3	64.3	
	100	10.2	7.2	205	330	66.4	66.4	66.9	
	150	10.2	7.8	270	340	73.3	73.3	74.3	
	200	10.2	8.4	325	350	80.1	79.9	82.0	
	250	10.2	9.0	385	360	88.0	87.6	91.5	
	300	10.2	9.6	440	370	96.2	95.8	101.4	
400	350	10.2	10.2	495	380	102.5	105.6	113.9	
	80	10.8	7.0	185	355	78.1	78.1	78.1	
	100	10.8	7.2	210	360	80.9	80.9	81.4	
	150	10.8	7.8	270	370	88.5	88.5	89.5	
	200	10.8	8.4	325	380	95.9	95.7	97.8	
	250	10.8	9.0	385	390	104.8	104.4	108.3	
450	300	10.8	9.6	440	400	113.8	113.4	119.0	
	350	10.8	10.2	500	410	121.3	124.4	132.7	
	400	10.8	10.8	560	420	129.7	135.3	146.6	
	80	11.4	7.0	190	385	93.3	93.3	93.3	
	100	11.4	7.2	215	390	96.5	96.5	97.0	
	150	11.4	7.8	270	400	104.4	104.4	105.4	
	200	11.4	8.4	330	410	113.3	113.1	115.2	
	250	11.4	9.0	390	420	123.1	122.7	126.6	
500	300	11.4	9.6	445	430	132.9	132.5	138.1	
	350	11.4	10.2	505	440	141.4	144.5	152.8	
	400	11.4	10.8	560	450	150.3	155.9	167.2	
	450	11.4	11.4	620	460	160.1	168.0	178.9	
	80	12.0	7.0	195	415	112.2	112.2	112.2	
	100	12.0	7.2	215	420	115.2	115.2	115.7	
	150	12.0	7.8	275	430	124.7	124.7	125.7	
	200	12.0	8.4	330	440	134.0	133.8	135.9	
500	250	12.0	9.0	390	450	144.9	144.5	148.4	
	300	12.0	9.6	450	460	156.2	155.8	161.4	
	350	12.0	10.2	505	470	165.1	168.2	176.5	
	400	12.0	10.8	565	480	175.6	181.2	192.5	
	450	12.0	11.4	620	490	185.8	193.7	204.6	
	500	12.0	12.0	680	500	197.2	212.4	224.1	



Flange on Tyton Tees

Unit : mm

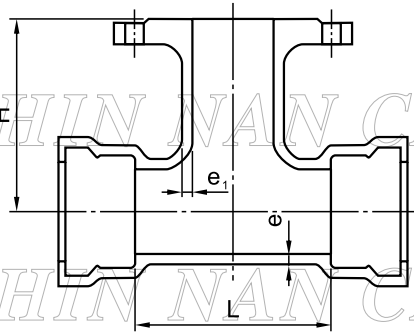

Nominal size		e	e ₁	L	H	Mass with flange (Kg)		
Body DN	Branch dn					PN 10	PN 16	PN 25
600	80	13.2	7.0	200	475	153.0	153.0	153.0
	100	13.2	7.2	220	480	156.8	156.8	157.3
	150	13.2	7.8	280	490	168.5	168.5	169.5
	200	13.2	8.4	340	500	180.6	180.4	182.5
	250	13.2	9.0	395	510	193.0	192.6	196.5
	300	13.2	9.6	455	520	206.5	206.1	211.7
	350	13.2	10.2	510	530	217.6	220.7	229.0
	400	13.2	10.8	570	540	230.3	235.9	247.2
	450	13.2	11.4	630	550	243.4	251.3	262.2
	500	13.2	12.0	685	560	256.3	271.5	283.2
700	600	13.2	13.2	800	580	287.7	312.5	328.4
	150	14.4	7.8	285	520	219.8	219.8	220.8
	200	14.4	8.4	345	525	234.0	233.8	235.9
	250	14.4	9.0	400	535	248.3	247.9	251.8
	300	14.4	9.6	460	540	263.7	263.3	268.9
	350	14.4	10.2	520	550	277.5	280.6	288.9
	400	14.4	10.8	575	555	290.8	296.4	307.7
	450	14.4	11.4	635	565	305.8	313.7	324.6
800	500	14.4	12.0	690	570	319.8	335.0	346.7
	600	14.4	13.2	810	585	354.5	379.3	395.2
	700	14.4	14.4	925	600	383.5	400.3	433.3
	150	15.6	7.8	290	580	281.0	281.0	282.0
	200	15.6	8.4	350	585	298.0	297.8	299.9
	250	15.6	9.0	410	595	316.0	315.6	319.5
	300	15.6	9.6	465	600	333.0	332.6	338.2
	350	15.6	10.2	525	610	349.6	352.7	361.0
	400	15.6	10.8	580	615	365.5	371.1	382.4
	450	15.6	11.4	640	625	383.3	391.2	402.1
900	500	15.6	12.0	700	630	401.1	416.3	428.0
	600	15.6	13.2	1045	645	494.4	519.2	535.1
	700	15.6	14.4	1045	660	510.3	527.1	560.1
	800	15.6	15.6	1045	675	518.4	537.6	586.8
	150	16.8	7.8	300	640	353.0	353.0	354.0
	200	16.8	8.4	355	645	371.5	371.3	373.4
	250	16.8	9.0	415	655	392.6	392.2	396.1
	300	16.8	9.6	470	660	412.4	412.0	417.6
	350	16.8	10.2	530	670	432.1	435.2	443.5
	400	16.8	10.8	590	675	452.2	457.8	469.1
	450	16.8	11.4	645	685	471.7	479.6	490.5
	500	16.8	12.0	705	690	492.5	507.7	519.4
	600	16.8	13.2	1170	705	637.2	662.0	677.9
	700	16.8	14.4	1170	720	653.5	670.3	703.3
	800	16.8	15.6	1170	735	662.0	681.2	730.4
	900	16.8	16.8	1170	750	671.8	695.7	756.1



Flange on Tyton Tees

Unit : mm

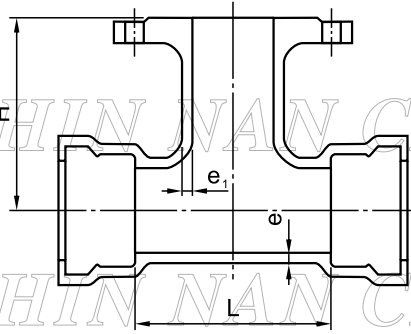

Nominal size		e	e ₁	L	H	Mass with flange (Kg)		
Body DN	Branch dn					PN 10	PN 16	PN 25
1000	150	18.0	7.8	305	700	433.7	433.7	434.7
	200	18.0	8.4	360	705	455.3	455.1	457.2
	250	18.0	9.0	420	715	479.7	479.3	483.2
	300	18.0	9.6	480	720	504.3	503.9	509.5
	350	18.0	10.2	535	730	525.6	528.7	537.0
	400	18.0	10.8	595	735	549.1	554.7	566.0
	450	18.0	11.4	650	745	571.6	579.5	590.4
	500	18.0	12.0	710	750	595.8	611.0	622.7
	600	18.0	13.2	1290	765	804.7	829.5	845.4
	700	18.0	14.4	1290	780	821.4	838.2	871.2
	800	18.0	15.6	1290	795	830.1	849.3	898.5
900	18.0	16.8	1290	810	840.4	864.3	924.7	
1000	18.0	18.0	1290	825	857.5	899.0	976.8	
1100	150	19.2	7.8	310	760	522.0	522.0	523.0
	200	19.2	8.4	370	765	548.8	548.6	550.7
	250	19.2	9.0	425	775	574.8	574.4	578.3
	300	19.2	9.6	485	780	603.0	602.6	608.2
	350	19.2	10.2	540	790	627.6	630.7	639.0
	400	19.2	10.8	600	795	654.7	660.3	671.6
	450	19.2	11.4	660	805	682.6	690.5	701.4
	500	19.2	12.0	715	810	708.5	723.7	735.4
	600	19.2	13.2	830	825	767.2	792.0	807.9
	700	19.2	14.4	950	840	823.2	840.0	873.0
	800	19.2	15.6	1065	855	886.5	905.7	954.9
900	19.2	16.8	1180	870	942.7	966.6	1027.0	
1000	19.2	18.0	1295	885	1005.8	1047.3	1125.1	
1100	19.2	19.2	1410	900	1075.5	1110.5	1183.4	
1200	150	20.4	7.8	315	820	628.4	628.4	629.4
	200	20.4	8.4	375	825	659.1	658.9	661.0
	250	20.4	9.0	430	835	688.7	688.3	692.2
	300	20.4	9.6	490	840	720.7	720.3	725.9
	350	20.4	10.2	550	850	751.2	754.3	762.6
	400	20.4	10.8	605	855	779.9	785.5	796.8
	450	20.4	11.4	665	865	811.6	819.5	830.4
	500	20.4	12.0	720	870	841.1	856.3	868.0
	600	20.4	13.2	840	885	909.6	934.4	950.3
	700	20.4	14.4	955	900	971.2	988.0	1021.0
	800	20.4	15.6	1070	915	1042.1	1061.3	1110.5
900	20.4	16.8	1185	930	1105.9	1129.8	1190.2	
1000	20.4	18.0	1300	945	1176.7	1218.2	1296.0	
1100	20.4	19.2	1420	960	1256.4	1291.4	1364.3	
1200	20.4	20.4	1535	975	1323.2	1387.5	1487.0	